



31st Annual

ANIMAL BEHAVIOR CONFERENCE

March 29 – 30, 2024

Plenary Speaker

Maydianne Andrade

University Professor

Canada Research Chair

Department of Biological Sciences

University of Toronto

“Control, Context, & Choosiness:
Flipping the lens to see female
plasticity in widow spiders”

Keynote Speaker

David Polly

Professor

Department Chair

Dept of Earth & Atmospheric Sciences

Indiana University

“Ambush! The evolutionary and
ecological origins of cat predatory
behaviors in the fossil record”



PROGRAM CONTENTS

PROGRAM IN BRIEF	2
WI-FI ACCESS AND CONVENTION CENTER ACCOMMODATIONS.....	3
INFORMATION FOR PRESENTERS	3
MONROE CONVENTION CENTER AND PARKING	4
PROGRAM SCHEDULE	
Friday talks	6
Poster presentations.....	9
Saturday talks.....	13
PLENARY AND KEYNOTE SPEAKER BIOGRAPHIES	16
ACKNOWLEDGEMENTS	17

Please see the conference website for abstracts of all talks and poster presentations:

<https://animalbehavior.indiana.edu/news-events/conference/schedule.html>



This is a public event where pictures will be taken, and you may be photographed during the conference.



This year we are offering an optional set of ribbons for your conference badge. These ribbons are meant to assist those folks who are actively looking for positions, to fill positions, and/or collaborators. There is a color scheme to assist in identifying interested parties.

PROGRAM IN BRIEF

FRIDAY, MARCH 29TH

TALKS

9:00 AM – 5:00 PM

Duke Energy Room West, Monroe Convention Center

POSTER SESSION

7:00 – 9:00 PM

Cook and Zebendon Rooms, Monroe Convention Center

SATURDAY, MARCH 30TH

TALKS

9:00 AM – 12:30 PM

Duke Energy Room West, Monroe Convention Center

CAREER PANEL

2:00 PM – 3:00 PM

Duke Energy Room West, Monroe Convention Center

KEYNOTE PRESENTATION

3:15 PM – 4:15 PM

Duke Energy Room West, Monroe Convention Center

CLOSING RECEPTION

4:30 PM – 6:00 PM

1st Floor Lobby, Monroe Convention Center

HOW TO DONATE TO CISAB

Registration for the IU Animal Behavior Conference is free. However, funding for the meeting depends on contributions from generous donors. Please consider donating to the Program in Animal Behavior Fund to help support future meetings.

Suggested Donation: Students - \$10, Faculty - \$30

Donate at www.myiu.org/one-time-gift

Search 'ANIMAL' to find "Program in Animal Behavior" or scan here →



WI-FI ACCESS

MONROE CONVENTION CENTER: Wi-Fi network: MCCC Guest WiFi
No password is required
For assistance, see Convention Center staff or call 812-336-3681

INDIANA UNIVERSITY CAMPUS: Wi-Fi network: eduroam
Must be set up through an eduroam subscriber institution
Alternative network: IU Guest
For assistance, contact UITS at 812-855-6789

ACCOMMODATIONS FOR NURSING MOTHERS

At the Convention Center, nursing mothers will be provided with a private office, electricity, and a refrigerator, if needed. Please see Convention Center staff at the front desk or call 812-336-3681.

INFORMATION FOR PRESENTERS

INSTRUCTIONS FOR SPEAKERS:

File Submission:

*Submit your presentation **at least two days** before your presentation day.*

Name your presentation file as follows:

PresentationDay_PresentationTime_LastName_FirstName_OperatingSystem.FileExtension.

Audio and video can be included in the PowerPoint presentations.

Additionally, any supplementary audio or video files can be submitted in a zipped file. Use the file name above and add “_Suppl” to the end of the filename.

After you have named your file(s) appropriately, email them to: aguilare@iu.edu

Files may be updated until the deadline by repeating this process with the same filename. We will use the most recent version.

Day of Presentation:

Please report to the speaker ready-table 10 minutes before your talk to be fit with a microphone. This table will be located in the back of the presentation hall.

At that time, you may indicate to the AV volunteers whether you would like your talk to be recorded.

INSTRUCTIONS FOR POSTER PRESENTERS:

Posters can be set up in the Cook and Zebendon Rooms any time after 1:00 PM on Friday, March 29th. You will receive your poster number, instructions for where to hang your poster, and hanging materials upon arrival. Posters should be taken with you after the poster session concludes.

Social media representatives may circulate during the session and request interviews of those who agreed to be video recorded.

You may make your poster available online by uploading it to our shared folder:

<http://tinyurl.com/ABC2024Posters>, PASSCODE: AnimalBehavior2024



MONROE CONVENTION CENTER

302 S. College Avenue
Bloomington, IN 47403

Phone: 812-336-3681
www.BloomingtonConvention.com

FIRST FLOOR

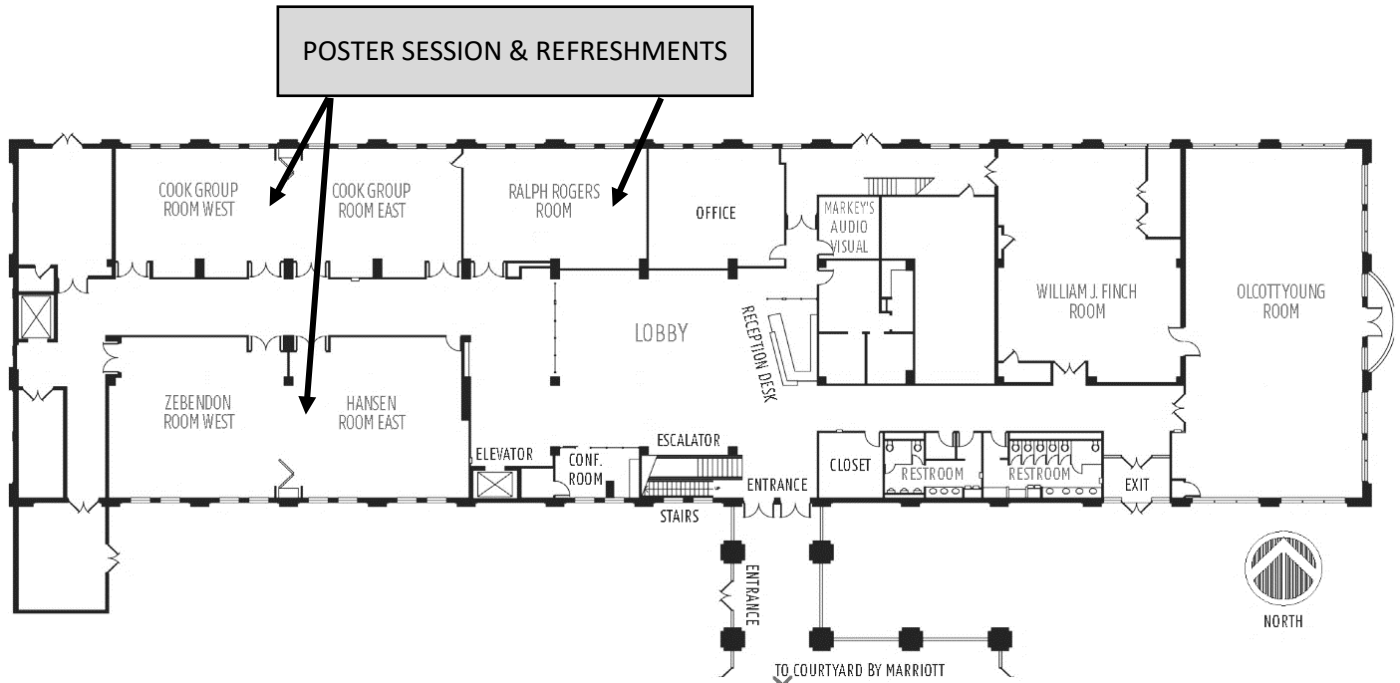

SECOND FLOOR

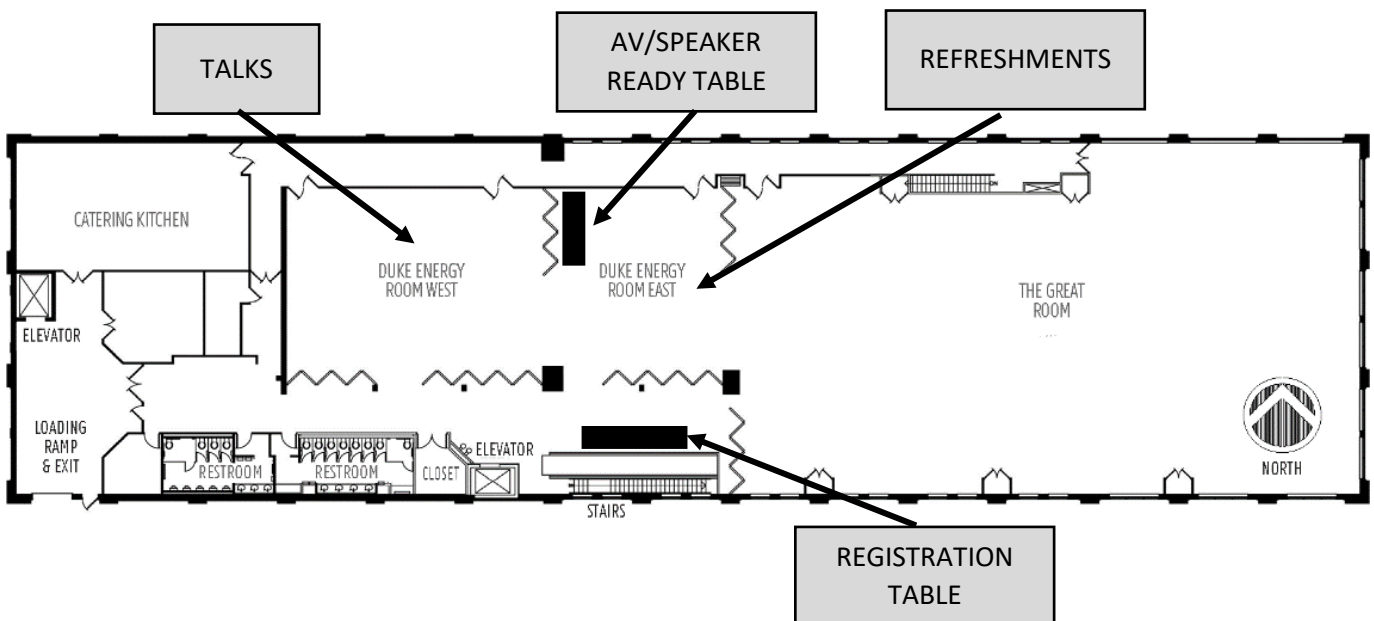

FREE PARKING AT CONVENTION CENTER

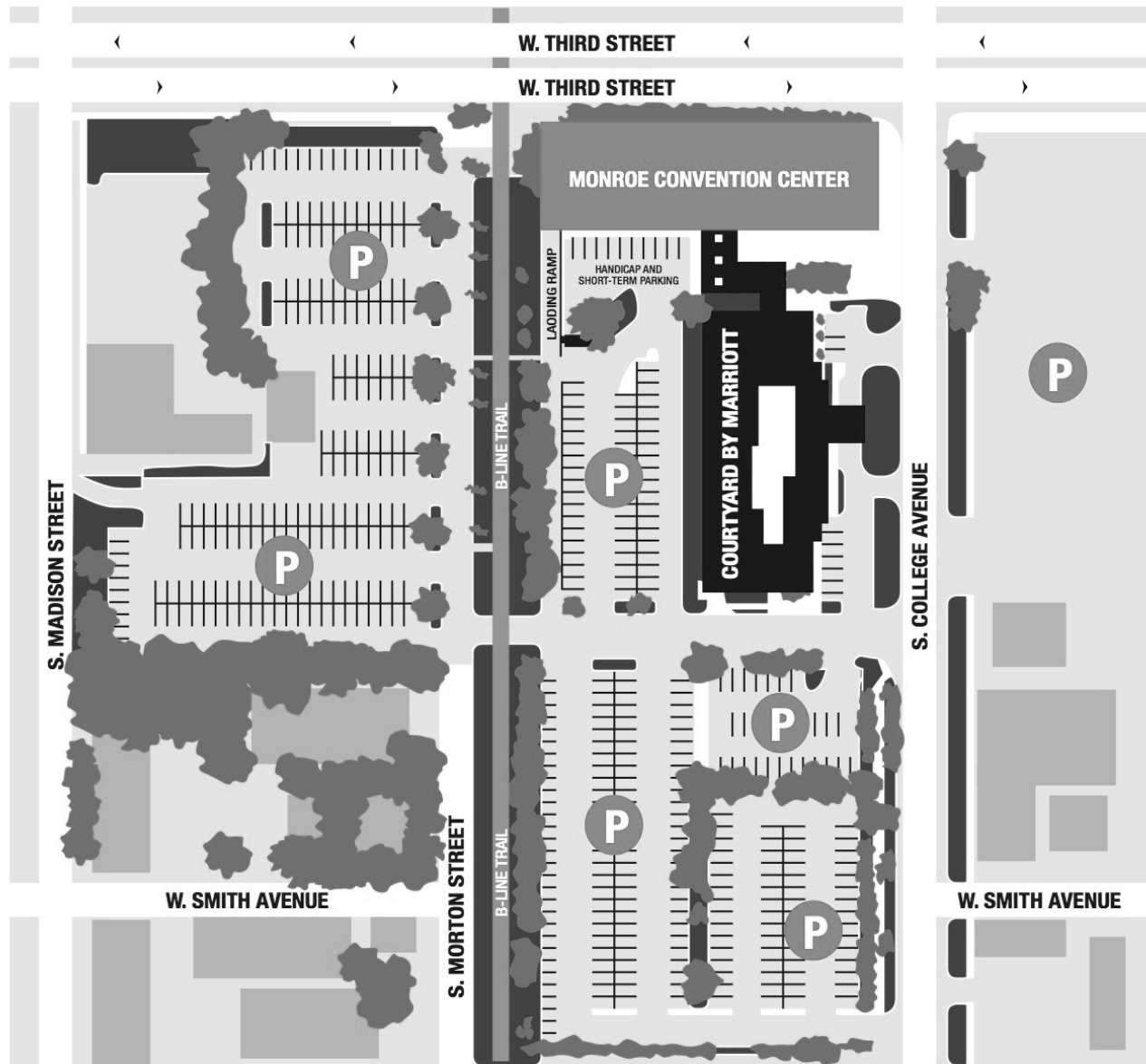

For updated information about transportation around Bloomington, please see the Accommodations page of the Animal Behavior Conference section on the CISAB website: <https://animalbehavior.indiana.edu/news-events/conference/accomodations.html>



FRIDAY, MARCH 29TH

SCHEDULE OF TALKS

DUKE ENERGY ROOM WEST, MONROE CONVENTION CENTER

Abstracts with complete author lists are available on the conference website:

<https://animalbehavior.indiana.edu/news-events/conference/schedule.html>



- 8:45 – 9:00 **Opening Remarks and Coffee**
Cara L. Wellman, Director, Center for the Integrative Study of Animal Behavior
- SESSION I **SOCIALITY I**
Moderator: Josie Fornara
- 9:00 – 9:15 **INVESTIGATION OF DIFFERENCES IN MOUSE AND PRAIRIE VOLE STRING-PULLING MOVEMENT ORGANIZATION**
Yessenia Chavez
Graduate Student, Department of Psychology, Northern Illinois University
- 9:15 – 9:30 **TADPOLE FIGHT CLUB: THE ONTOGENY OF AGGRESSION IN POISON FROG TADPOLES**
Lisa L Surber-Cunningham
Graduate Student, Department of Evolution, Ecology & Behavior, University of Illinois Urbana-Champaign
- 9:30 – 9:45 **ASOCIAL TESTING OF SOCIAL SPECIES: STRESS-TESTING THE ECOLOGICAL VALIDITY OF OUR ANIMAL BEHAVIOR ASSAYS**
Scott A Benson
Graduate Student, Department of Psychology, University of Tennessee
- REFRESHMENT BREAK
- SESSION II **SENSORY PERCEPTION**
Moderator: Cassandra Sheridan
- 10:00 – 10:15 **LAND HO! POLARIZED LIGHT SERVES AS A VISUAL SIGNAL FOR LANDWARD ORIENTATION IN DISPLACED SPIDERS**
Brian G Gall
Faculty, Biology Program, Hanover College
- 10:15 – 10:30 **DINING ON THE CROAK TUNE: ACOUSTIC HOST-SEEKING BEHAVIOR IN FROG-BITING MOSQUITOES, *URANOTAENIA LOWII***
Richa Singh
Postdoctoral Fellow, Department of Biological Sciences, Purdue University
- 10:30 – 10:45 **WHAT'S THE RUMPUS? THE INTERCONTINENTAL PERCEPTION OF AVIAN ALARM CALLS**
Jonah S Dominguez
Graduate Student, Program in Ecology, Evolution & Conservation, University of Illinois Urbana-Champaign

10:45 – 11:00 **FROM UNDERSTORY TO CANOPY: FROG SIGNAL DEGRADATION IN A TROPICAL FOREST**
Katherine González
Graduate Student, Department of Biological Sciences, Purdue University

REFRESHMENT BREAK

SESSION IV **NEURAL MECHANISMS OF BEHAVIOR**
Moderator: Hannah Fink

11:15 – 11:30 **TOTAL NUMBER OF NEURONS IS NOT NECESSARILY A BETTER MEASURE OF COGNITIVE ABILITY THAN OVERALL BRAIN SIZE**
P. Thomas Schoenemann
Faculty, Cognitive Science Program, Indiana University

11:30 – 11:45 **MAPPING MOUSE AUDITORY BEHAVIOR IN THE BRAIN**
Simran Singh
Graduate Student, Department of Evolution, Ecology & Behavior, University of Illinois Urbana-Champaign

11:45 – 12:00 **CRYPTIC GENETIC VARIATION IN BRAIN GENE EXPRESSION PRECEDES THE EVOLUTION OF CANNIBALISM**
Dante J Nesta
Graduate Student, Department of Biology, Indiana University

12:00 – 12:15 **UNVEILING THE NEURAL CORRELATES OF MOSQUITO BEHAVIOR: USE OF ACOUSTIC SIGNALS ACROSS DIFFERENT ECOLOGICAL CONTEXTS**
Shilpi Singh
Postdoctoral Fellow, Department of Biological Sciences, Purdue University

LUNCH BREAK

SESSION IV **PARASITISM AND PREDATION**
Moderator: Morgan Familo

1:45 – 2:00 **EFFECTS OF NEST PARASITE ABUNDANCE ON BEE-BHAVIOR IN CHIMNEY BEES (*ANTHOPHORA ABRUPTA*)**
Erika Dalliance
Graduate Student, Department of Ecology and Evolutionary Biology, University of Tennessee

2:00 – 2:15 **EYE COLOR IS UNLIKELY TO SERVE AS A STARTLE MECHANISM IN RED-EYED TREE FROGS *AGALYCHNIS CALLIDRYAS***
Jax D Betzner
Undergraduate Student, Biology Program, Hanover College

2:15 – 2:30 **DIVERSE HOST-FEEDING STRATEGIES IN AN UNDERSTUDIED TRIBE OF MOSQUITOES**
Sydney Moeller
Undergraduate Student, Department of Biological Sciences, Purdue University

- 2:30 – 2:45 **THE INTERACTIVE EFFECTS OF *WOLBACHIA* AND *NOP60B* ON SINDBIS VIRUS REPLICATION**
Nicole Stark
Graduate Student, Department of Biology, Indiana University
- SESSION V **SOCIALITY II**
Moderator: Lindsay Stolting
- 3:00 – 3:15 **THE ROLE OF ISOTOCIN IN THE DIVERGENT PARENTAL CARE BEHAVIOR OF TWO STICKLEBACK POPULATIONS**
Meghan F Maciejewski
Graduate Student, Department of Evolution, Ecology & Behavior, University of Illinois Urbana-Champaign
- 3:15 – 3:30 **LONELY AND LISTENING: SEX AND SOCIAL ISOLATION INFLUENCE SOCIABILITY DURING SQUEAK PLAYBACK**
Lauren R Brunner
Graduate Student, Department of Biology, Indiana University
- 3:30 – 3:45 **CAUSES AND CONSEQUENCES OF BEHAVIORAL VARIATION: INSIGHTS THROUGH THE STUDY OF HONEY BEES AND DUNG BEETLES**
Rebecca R Westwick
Postdoctoral Fellow, Department of Biology, Indiana University
- 4:00 – 5:00 **PLENARY SESSION:
CONTROL, CONTEXT & CHOOSINESS: FLIPPING THE LENS TO SEE FEMALE PLASTICITY IN WIDOW SPIDERS**
Maydianne Andrade
Faculty, Department of Biological Sciences, University of Toronto Scarborough

POSTER PRESENTATIONS

Please reconvene this evening for our annual poster session.

7:00 – 9:00 PM

Cook and Zebendon Rooms, Monroe Convention Center

Hors d'oeuvres will be served in the adjacent Ralph Rogers Room

See pages 9-12 for poster titles and numbers.

Full abstracts are available on the conference website:

<https://animalbehavior.indiana.edu/news-events/conference/schedule.html>

Posters may be made available online through our shared OneDrive folder:

<http://tinyurl.com/ABC2024Posters>



POSTER PRESENTATIONS

FRIDAY, MARCH 29TH, COOK AND ZEBENDON ROOMS, MONROE CONVENTION CENTER

Poster numbers alphabetical by presenter last name (**bold** if not first author)

Full abstracts can be found on the conference website:

<https://animalbehavior.indiana.edu/news-events/conference/schedule.html>



- 1 **EFFECT OF ARTIFICIAL LIGHT AT NIGHT (ALAN) AND TRAFFIC NOISE ON ANURAN COMMUNICATION**
Bustos AA¹, Ospina AM¹, Bernal XE^{1,2}
¹Department of Biological Sciences, Purdue University; ²Smithsonian Tropical Research Institute

- 2 **THE EFFECTS OF TACTILE CUES ON CALIBRATING THE ORGANIZATION OF OPEN FIELD BEHAVIOR**
Campbell N, Sampson H, Schaeffer E, Lake R, Wallace D
Department of Psychology, Northern Illinois University

- 3 **STUDYING HOST PREFERENCE AND ITS CONTRIBUTION TO THE CO-OCCURRENCE OF ENTOMOPATHOGENIC NEMATODES**
Cortes Romero M², Enriquez Madrid J¹, Bashey-Visser F¹
¹Department of Biology, Indiana University; ²Department of Animal Science, Cornell University

- 4 **PRENATAL ALCOHOL EXPOSURE INCREASES IMPULSIVITY IN ADOLESCENT MALE, BUT NOT FEMALE RATS**
Perkins A, Norman T, **Dart E**, Kinney L
Department of Psychology, Purdue University Fort Wayne

- 5 **MULTIGENERATIONAL EFFECTS OF DREDGE-AMENDED CORN ON BEHAVIORAL DEVELOPMENT**
Durkin BD, Czuba MI, Flanigan KAS, Willing J
Department of Psychology, Bowling Green State University

- 6 **DO DIFFERENCES IN HOST PREFERENCE AND INFECTION STRATEGY FACILITATE PARASITE COEXISTENCE?**
Enriquez Madrid J¹, Cortes Romero M³, Myung-won Kim L², Bashey-Visser F¹
¹Department of Biology and ²Program in Neuroscience, Indiana University Bloomington; ³Department of Animal Science, Cornell University

- 7 **RISK ASSESSMENT GUIDES NEST DEFENSE BEHAVIORS IN FEMALE HOUSE WRENS (*TROGLODYTES AEDON AEDON*)**
Fornara JH¹, Eggleston RC², and Reichard DG²
¹Department of Biology, Indiana University; ²Department of Biological Sciences, Ohio Wesleyan University

- 8 **HEAD-BOBBING: WHAT CAN WE LEARN FROM A SINGLE ELEPHANT?**
Fowler AR¹, Burns-Cusato M², White B², Taylor S³
¹Biology Program and ²Department of Behavioral Neuroscience, Centre College; ³Louisville Zoo

- 9 **SHORT-TERM MELATONIN INJECTIONS INFLUENCES ON DEFENSIVE AGGRESSION IN FEMALE SIBERIAN HAMSTERS (*PHODOPUS SUNGORUS*)**
Greenwell D², Han A¹, Demas G¹
¹Department of Biology, Indiana University; ²Department of Biology, Saint Francis University

- 10 **UNDERSTANDING THE EVOLUTIONARY PUZZLE OF VARIATION IN MATERNAL CARE IN NORTH AMERICAN RED SQUIRRELS**
Griffin EA¹, Boutin S³, Lane JE⁴, McAdam AG⁵, Dantzer B^{1,2}
¹*Department of Psychology and* ²*Department of Ecology and Evolutionary Biology, University of Michigan;* ³*Department of Biological Sciences, University of Alberta;* ⁴*Department of Biology, University of Saskatchewan;* ⁵*Department of Ecology and Evolutionary Biology, University of Colorado*

- 11 **CONSTRUCTING SOCIAL NICHES IN GOULDIAN FINCH (*CHLOEBIA GOULDIAE*) FLOCKS IS PREDOMINANTLY INFLUENCED BY FEMALES**
Haag A, Kohn G
Department of Psychology, University of North Florida

- 12 **LONG-TERM MELATONIN ADMINISTRATION INDUCES A SEASONAL SWITCH IN DEFENSIVE AGGRESSION IN SIBERIAN HAMSTERS (*PHODOPUS SUNGORUS*)**
Han Y, Demas GE
Department of Biology, Indiana University

- 13 **INVESTIGATING RECEPTIVE AND PRODUCTIVE SYMBOL USE IN RHESUS MACAQUES (*MACACA MULATTA*)**
Jackson BN, Sanchez A, Church BA, Smith JD
Department of Psychology and Language Research Center, Georgia State University

- 14 **DOING WHAT YOUR NEIGHBOURS DO: FINDING EVIDENCE OF SOCIAL INTERACTION WITHIN AN EGG CLUTCH USING NETWORK-BASED DIFFUSION MODELS.**
Johnson J¹, Hasenjager M², Ward J¹
¹*Department of Biology, Ball State University;* ²*National Institute of Mathematical and Biological Synthesis, University of Tennessee Knoxville*

- 15 **A COMPARISON OF REPRODUCTIVE METRICS IN CAPTIVE AND WILD DARK-EYED JUNCOS**
Kelson AS, Wanamaker SM, Ketterson ED
Department of Biology, Indiana University

- 16 **EXAMINING THE NEUROBIOLOGICAL AND BEHAVIORAL EFFECTS OF NEURONAL DDIT4 OVEREXPRESSION IN THE MEDIAL PREFRONTAL CORTEX OF MICE**
Kuhn AM¹, Bosis KE², Jerow L², Larke Vollmer L¹, Bollinger JL¹, Wohleb ES¹
¹*Department of Pharmacology & Systems Physiology and* ²*Neuroscience Graduate Program, University of Cincinnati*

- 17 **EFFECTS OF BROODING STATUS ON LIPID PEROXIDATION AND MITOCHONDRIAL FUNCTION IN A MOUTHBROODING AFRICAN CICHLID FISH**
Mitchell H¹, Dolben E², Buzinski O¹, Dijkstra PD¹
¹*Department of Biology, Central Michigan University;* ²*School of Biological Sciences, University of Manchester*

- 18 **INNOVATION AND DIVERSIFICATION OF AND THROUGH SEXUAL DIMORPHISM: INSIGHTS FROM HORNED BEETLES**
Nadolski EM, Moczek AP
Department of Biology, Indiana University

- 19 **POTENTIAL CHEMICAL REPRODUCTIVE COMMUNICATION IN BABOONS**
 Neufell T¹, Nonnamaker L¹, Lightcap I², Archie B¹
¹Department of Biological Sciences and ²Center for Sustainable Energy, University of Notre Dame
- 20 **COMPARATIVE PHYLOGENETIC ANALYSIS OF DUETTING AND OTHER LIFE HISTORY TRAITS IN THE AVIAN ORDER STRIGIFORMES**
 Nieves DR¹, Goldberg D¹, Araya-Salas M², Odom K³
¹Department of Biology, Albion College; ²School of Biology, University of Costa Rica; ³Department of Biological Sciences, University of the Pacific
- 21 **FREQUENCY OF AFFILIATIVE BEHAVIOR AMONG NON-ORPHANED AND ORPHANED AFRICAN SAVANNA ELEPHANTS *LOXODONTA AFRICANA***
 Resonno Jr S¹, Chusyd DE²
¹Department of Zoology, Southern Illinois University; ²Department of Environmental and Occupational Health, Indiana University
- 22 **DIFFERENTIAL ANTIPREDATOR RESPONSES OF TWO-LINE SALAMANDER LARVAE TO TWO SPECIES OF PREDATORY CRAYFISH**
 Ronk S, Winn CM, Betzner J, Gall BG
Department of Biology, Hanover College
- 23 **POTENTIAL INFLUENCES OF ANTI-AGING SUPPLEMENTS ON NEONATAL BEHAVIORS IN *RATTUS NORVEGICUS***
 Ruby H, Willing J
Department of Psychology, Bowling Green State University
- 24 **EFFECTS OF LARVAL DIET AND DENSITY ON BRAIN MORPHOLOGY AND GENE EXPRESSION PLASTICITY IN *SPEA BOMBIFRONS***
 Sequeira A¹, Ledón-Rettig C², Lagon S³, Nesta D²
¹Department of Psychology, Tufts University; ²Department of Biology, Indiana University Bloomington; ³CDC National Center of Environmental Health
- 25 **REPLAY OF INCIDENTALLY ENCODED NOVEL ODORS IN THE RAT**
 Sheridan C¹, Bonner L^{1,2}, Crystal JD¹
¹Department of Psychological and Brain Sciences, Indiana University; ²Department of Cognitive, Linguistic, and Psychological Sciences, Brown University
- 26 **COMPARING NATURAL AND DRUG REWARD SENSITIVITY IN NON-FOOD RESTRICTED RAT MODEL**
 Shultz E, Thompson K, Cromwell HC
Department of Psychology, Bowling Green State University
- 27 **EFFECT OF HEAT STRESS ON ZEBRA FINCH COMMUNICATION**
 Smith T, Empson T, Derryberry E
Department of Ecology and Evolutionary Biology, University of Tennessee Knoxville
- 28 **FEAR FACTOR: HOW EMBRYONIC EXPOSURE TO CONSPECIFIC ALARM CUES IMPACTS BEHAVIOR AND DEVELOPMENT IN *PIMEPHALES PROMELAS***
 Steinberg K, Ward J
Department of Biology, Ball State University

- 29 **MATERNAL DEFENSE STRATEGIES: INVESTIGATING FEMALE AGGRESSION IN DYING POISON FROG, *DENDROBATES TINCTORIUS***
Strohmeier IR, Westrick SE, Fischer EK
School of Integrative Biology, University of Illinois Urbana-Champaign
- 30 **ARTIFICIAL LIGHT AT NIGHT AND PARASITE LOADS IN THE DARK-EYED JUNCO (*JUNCO HYEMALIS*)**
Tysver AM, Diedrich SS, Wanamaker SM, Talbott KM, Ketterson ED
Department of Biology, Indiana University Bloomington
- 31 **UNRAVELING THE NET: EXPLORING THE IMPACT OF SOCIAL REGROUPING ON BEHAVIOR AND PERINEURONAL NET DEVELOPMENT, A MARKER OF NEUROPLASTICITY**
Varman S, Coutellier L
Department of Psychology, The Ohio State University
- 32 **THE EFFECT OF ANTHROPOGENIC ACTIVITY & VARIATION IN BODY CONDITION ON MATERNAL BEHAVIOR IN *MACACA FASCICULARIS***
Velarde Chong AS¹, Coggeshall E²
¹Department of Wildlife, Cal Poly Humboldt; ²Department of Anthropology, Indiana University Bloomington
- 33 **THE EFFECT OF SEX AND MATING STATUS ON METABOLIC ACTIVITY AND RESOURCE ALLOCATION IN *G. VOCALIS* CRICKETS**
Von Deylen MF¹, Muñoz-García A², Gershman SN³
¹Department of Evolution, Ecology, and Organismal Biology, The Ohio State University; ²Department of Evolution, Ecology, and Organismal Biology, The Ohio State University at Mansfield; ³Department of Evolution, Ecology, and Organismal Biology, The Ohio State University at Marion
- 34 **THE EFFECTS OF MICROBIAL SYMBIOTES ON ENTOMOPATHOGENIC NEMATODES**
Weston S¹, Familo M², Bashey-Visser F²
¹Department of Biology, Truman State University; ²Department of Biology, Indiana University
- 35 **THE EFFECTS OF ECOLOGICALLY RELEVANT AND IRRELEVANT SOUNDS ON EARTHWORM BEHAVIOR IN AN OPEN FIELD ENVIRONMENT**
Worthen B, Herb L, Arzola E, Burton A, Claflin D
Department of Psychology, Wright State University
- 36 **LOST IN THE K-HOLE: USING THE PAVLOVIAN CONDITIONED APPROACH TO PREDICT PERFORMANCE IN A PROGRESSIVE RATIO SCHEDULE OF REINFORCEMENT UNDER SUBANESTHETIC KETAMINE IN SPRAGUE-DAWLEY RATS**
Wright C, Muscott S, Akinbo-Jacobs O, Matuszewich L
Department of Psychology, Northern Illinois University
- 37 **EMBRYONIC ASSOCIATIVE LEARNING IN FATHEAD MINNOWS (*PIMEPHALES PROMELAS*)**
Sodo L, Yake A, Ward J
Department of Biology, Ball State University
- 38 **A NEW BIO-LOGGING SYSTEM UNVEILS BEHAVIOR OF PRAIRIE VOLES IN SEMI-NATURAL FIELD ENCLOSURES**
Zhang M^{1,2}, Gaidica M^{2,4}, Burkett J⁵, Dantzer B^{2,3}
¹School for Environment and Sustainability, ²Department of Psychology, and ³Department of Ecology & Evolutionary Biology, University of Michigan; ⁴Department of Neuroscience, Washington University; ⁵Department of Neurosciences, University of Toledo

SATURDAY, MARCH 30TH

SCHEDULE OF TALKS

DUKE ENERGY ROOM WEST, MONROE CONVENTION CENTER

Abstracts with complete author lists are available on the conference website:

<https://animalbehavior.indiana.edu/news-events/conference/schedule.html>



- 8:45 – 9:00 **Opening Remarks and Coffee**
Cara L. Wellman, Director, Center for the Integrative Study of Animal Behavior
- SESSION VI **HUMAN IMPACTS ON BEHAVIOR**
Moderator: Maire O'Malley
- 9:00 – 9:15 **MICROPLASTICS ARE PRESENT IN EPHEMERAL POOLS AND ELEPHANT DIGESTIVE TRACTS IN KRUGER NATIONAL PARK**
Alec Iruri-Tucker
Graduate Student, Department of Environmental Health, Indiana University
- 9:15 – 9:30 **HOT OR NOT? THE EFFECTS OF TEMPERATURE ON AMPHIBIAN GLUCOCORTICOID REGULATION**
Eleanor R Shell
Graduate Student, Department of Biology, Indiana University
- 9:30 – 9:45 **TRAFFIC NOISE EFFECTS ON ANURAN VOCALIZATIONS: METHODOLOGICAL CHALLENGES AND OPPORTUNITIES**
Ana Maria Ospina
Graduate Student Department of Biological Sciences, Purdue University
- 9:45 – 10:00 **WHO CAN TAKE THE HEAT? INVESTIGATING TRANSCRIPTOMIC SIGNATURES OF THERMAL RESILIENCE IN A SONGBIRD**
Tara A Empson
Graduate Student, Department of Ecology and Evolutionary Biology, University of Tennessee
- REFRESHMENT BREAK
- SESSION VII **BEHAVIORAL PLASTICITY**
Moderator: Rebecca Westwick
- 10:15 – 10:30 **BEHAVIORAL AND HORMONAL EVALUATION OF FOUR METHODS OF REINFORCEMENT TRAINING IN DONKEYS *EQUUS ASINUS***
Isabella Maria Liberti
Graduate Student, Ross University School of Veterinary Medicine
- 10:30 – 10:45 **PREDICTING THE FUTURE: MECHANISMS OF ANTICIPATORY REPRODUCTION IN NORTH AMERICAN RED SQUIRRELS**
John Paul Williams-Soriano
Graduate Student, Department of Psychology, University of Michigan

- 10:45 – 11:00 **HOW SKIN COLOR MODULATES BEHAVIORAL FEVER IN NORTHERN LEOPARD FROGS**
 Ethan A Guardado
Undergraduate Student, Department of Biological Sciences, Purdue University
- 11:00 – 11:15 **EVALUATING REWARD RELATIVITY IN ALCOHOL PREFERRING RATS USING AN INCENTIVE CONTRAST PARADIGM**
 Kristina M Thompson
Graduate Student, Neural & Cognitive Sciences Program, Bowling Green State University
- 11:15 – 11:30 **GENETIC REGULATORS OF A RESOURCE POLYPHENISM INTERACT TO COUPLE PREDATORY MORPHOLOGY AND BEHAVIOR**
 Rose M Nicholson
Undergraduate Student, Department of Biology, Indiana University

REFRESHMENT BREAK

- SESSION VIII **DEVELOPMENT**
 Moderator: Erica Nadolski
- 11:45 – 12:00 **EARLY LIFE PAIN ALTERS THE RESPONSE TO AN IMMUNE CHALLENGE IN ADULT MALE AND FEMALE RATS**
 Morgan Gomez
Graduate Student, Neuroscience Institute, Georgia State University
- 12:00 – 12:15 **DOES PUBERTAL ONSET AFFECT BEHAVIORS MEDIATED BY THE DOPAMINE SYSTEM?**
 Victoria Ray Riesgo
Graduate Student, Psychology Department, Bowling Green State University
- 12:15 – 12:30 **EFFECTS OF ADOLESCENT CARDIOVASCULAR AND RESISTANCE TRAINING EXERCISE IN MALE AND FEMALE RATS**
 Antonio James Gonzalez
Research Assistant, Psychology Department, Bowling Green State University

LUNCH BREAK

- 2:00 – 3:00 **CAREER PANEL**
 PANELISTS: Jess Cusick, Michelle Benavidez-Westrich, and Zoe Dinges
- 3:15 – 4:15 **KEYNOTE PRESENTATION:**
AMBUSH! THE EVOLUTIONARY AND ECOLOGICAL ORIGINS OF CAT PREDATORY BEHAVIORS IN THE FOSSIL RECORD
 P David Polly
Department of Earth and Atmospheric Sciences, Indiana University
- 4:15 – 4:30 **AWARDS AND CLOSING REMARKS**
- 4:30 – 6:00 **CLOSING RECEPTION**

CAREER PANEL

Panelists will discuss their diverse career paths and answer audience questions.

2:00 – 3:00 PM

Duke Energy Room West, Monroe Convention Center

Invited speakers:

Dr. Jess Cusick (*Assistant Professor, Utah Valley University*)

Dr. Michelle Benavidez-Westrich (*Health Program Supervisor, IN Department of Natural Resources; Adjunct Instructor, Paul H. O'Neill School, Indiana University*)

Dr. Zoe Dinges (*Food Safety Coordinator and GLP study director, Valent BioSciences*)

CLOSING RECEPTION

Following the keynote presentation, we will present awards. Then, please join us for a closing reception at the Convention Center.

4:30 – 6:00 PM

1st Floor Lobby, Monroe Convention Center

PLENARY AND KEYNOTE SPEAKER BIOGRAPHIES

PLENARY SPEAKER

MAYDIANNE ANDRADE, Ph.D., FRCGS

UNIVERSITY PROFESSOR, UNIVERSITY OF TORONTO SCARBOROUGH



Dr. Maydianne Andrade is a Professor of Biological Sciences at the University of Toronto, Scarborough. She received her PhD in Neurobiology and Behavior from Cornell University in 2000. Through both field and laboratory studies, her research focuses on ecological and social factors influencing reproductive tactics in *Latrodectus* spider species. She is a co-founder and current president of the Canadian Black Scientists Network, as well as the founder and co-chair of the Toronto Initiative for Diversity and Excellence. Her dedication to science communication and outreach has culminated in numerous podcast and documentary appearances, including on *The Nature of Things*, and CBC Radio's *Ideas*.

KEYNOTE SPEAKER

P. DAVID POLLY, Ph.D.

PROFESSOR, INDIANA UNIVERSITY BLOOMINGTON



Dr. David Polly is a Professor in the Department of Earth and Atmospheric Sciences at IU, Bloomington. He is also affiliated with the departments of Biological Sciences and Anthropology. He received his PhD in Paleontology from the University of California, Berkely in 1993. Presently, his research focuses on how mammals respond to environmental changes over evolutionary time, and on identifying the markers of this process in fossil records, genomic data, and extant species. He is also the Research Curator of the IU Paleontological Collection and a Research Associate at the Field Museum of Natural History.

ACKNOWLEDGEMENTS

CISAB ADMINISTRATION

Program Director: Dr. Cara L. Wellman

Program Assistant: Jessica Smith

Laboratory Director: David Sinkiewicz

Administrative Assistant: Charli Taylor



CONFERENCE ORGANIZERS

Program Committee

Lindsay Stolting (Chair)

Josie Fornara

Hannah Fink

Dante Nesta

Lauren Brunner

Maire O'Malley

Abel Cong

Promotions Committee

Liz Aguilar (Chair)

Ellie Shell

Josie Fornara

Social Media Coordinators

Liz Aguilar (Chair)

Lauren Brunner

Socializing Committee

Amanda Han (Chair)

Maire O'Malley

Hannah Fink

Poster Session Committee

Lindsay Stolting (Chair)

Dante Nesta (Co-Chair)

Maire O'Malley

David Sinkiewicz

Undergraduate Poster Judges

Dante Nesta (Chair)

Emily Levy

Maire O'Malley

Ellie Shell

Lindsay Stolting

Audio Visual Committee

Liz Aguilar (Chair)

David Sinkiewicz

Lauren Brunner

Amanda Han

Registration Table Staff

Charli Taylor (Chair)

Jessica Smith

Photography Coordinators

Lauren Brunner

Abel Cong

Hannah Fink

Program Cover Artist

Michelle Benavidez

FUNDING SOURCES

Indiana University Office of the Bicentennial

Indiana University College of Arts and Sciences

The Hanna Kolodziejwski Fellowship Fund

The William J. Rowland Mentorship Award Fund

Indiana University Department of Biology

Indiana University Department of Psychological and Brain Sciences

The Program in Animal Behavior Fund



Program in Animal Behavior

Center for the Integrative Study of Animal Behavior

Indiana University Bloomington

409 North Park Avenue
Bloomington, IN 47405

(812) 855-9663
abeh@indiana.edu

